



**ROSELAND**  
DEVELOPERS

# A Home That Reflects Your Status & Nurtures Your Family

Limited-edition **3 BHK floors** where elegance meets comfort,  
offering a serene space your family will truly call its own.

**BOOK NOW**



A - 341



Limited Floors  
**AVAILABLE**

[roselanddevelopers.com](http://roselanddevelopers.com)

A-341, BPTP Astaire Garden,  
SPR Rd, Sector 70A, Gurugram



**ROSELAND**  
DEVELOPERS

**PLOT NO. A-341**

**3BHK+3T**

140 SQYD 3 SIDE OPEN

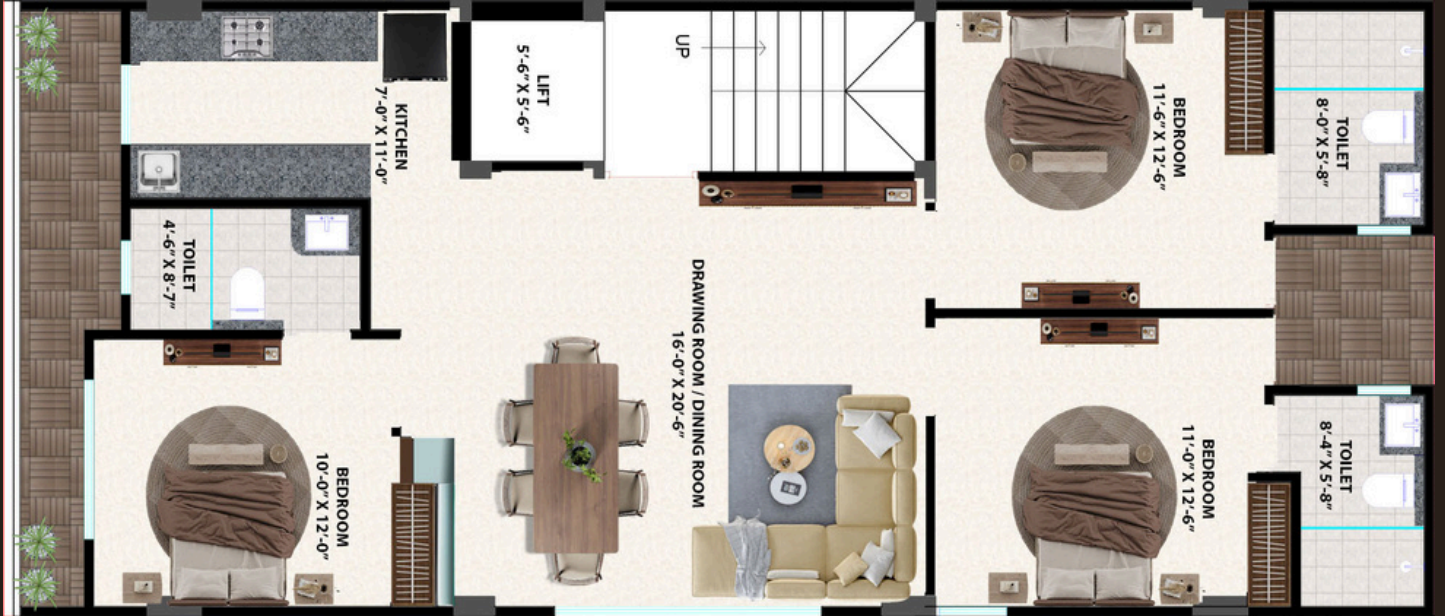

**FLOOR PLAN**

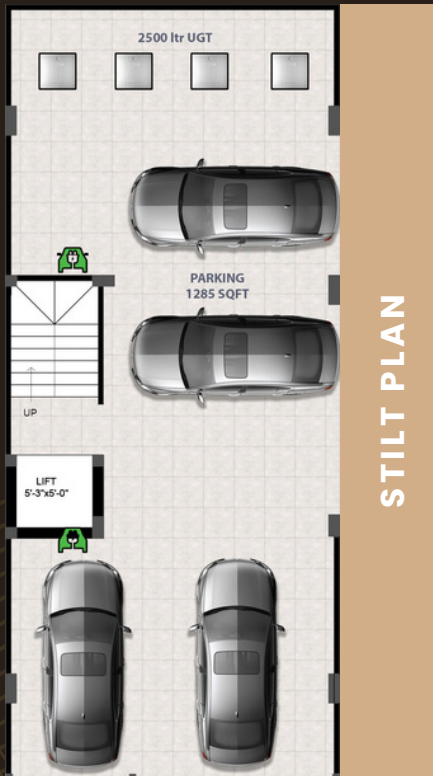

**STILT PLAN**



**TERRACE PLAN**



## PROPERTY SPECIFICATIONS

- ✓ 3 Bedrooms
- ✓ Private Terrace
- ✓ Full Basement Right
- ✓ Elevator
- ✓ Modern Kitchen
- ✓ Private Parking
- ✓ Premium Fittings
- ✓ Seepage Warranty
- ✓ Premium Interiors
- ✓ Exterior Waterproof Paint
- ✓ Entire Floor Waterproofing
- ✓ 5yrs. Anti-Termite Treatment Warranty

**Private Terrace** – Full Roof Rights, Pergola, Bar Counter, Pantry, Washroom, Sitting Area

**Basement**– Full Basement Rights, Modular Pantry, Fully Loaded Washroom, Store Room.

## AMENITIES



Yoga & Gym



Butterfly Garden



24X7 Security



Club House



24X7 Water Supply



Kids Play Area



Lift, Lobby



3 Acres Park



CCTV Camera



Parking



Pool Table



1 Years Maintenance



Restaurant

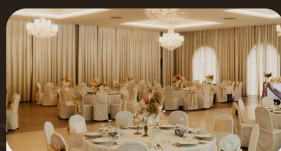

Banquet Hall



Theater

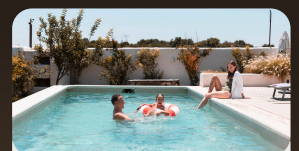

Heated Pool



Swimming Pool



Steam & Spa

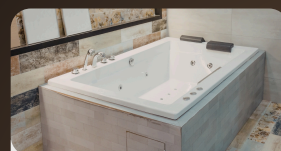

Jacuzzi



Indoor Library



**ROSELAND**  
DEVELOPERS

## LOCATION ADVANTAGES

BPTP GreenOaks

Private Living, Paerfectly Connected

Peaceful sanctuary with seamless access to retail, education, hotels & corporate hubs.



### HOSPITALS & CLINICS

- ANANTA HOSPITAL
- PARK HOSPITAL
- CLOUD NINE
- MEDANTA
- FORTIS
- MAX HOSPITAL

### EDUCATIONAL INSTITUTES

- ST. ANGELS
- INDUS WORLD SCHOOL
- KUNSKAPSSKOLAN INTERNATIONAL
- SURAJ SCHOOL
- ST. XAVIER'S
- SD ADARSH VIDYALAYA
- DPS
- SUNCITY SCHOOL
- SHIV NADAR

### HOTELS

- RADISSON
- COUNTRY INN

### OFFICES & BUSINESS PARKS

- AIR INDIA
- INTELLION EDGE
- CORPORATE GREENS
- PALAZZO
- BUSINESS PARK
- MEGAPOLIS
- TRADE CENTRE
- AMEX CORPORATE OFFICE
- CYBER CITY

### RETAIL

- D'MART
- CITY CENTRE
- GOOD EARTH CITY CENTER
- CELEBRATION MALL
- ELAN EPIC